

- DATA APPLICATIONS ONLY.
- MINIMAL USE OF PC BOARD AREA (<1.0"/25.4mm SQUARE).
- LOW PROFILE (<.525"/13.34mm)
- 2 TO 4 WIRE HYBRID TRANSFORMER "WET" AND "DRY".
- IMPEDANCE RATIOS OF 600 Ω : 600/600 Ω.
- UL RECOGNIZED COMPONENT - UL 1863, FILE E138250.

REVISIONS			
DATE	REV	DESCRIPTION	APPV'D
1-14-02	-1	Chg'd .500" ref. to Max	TJK
04-13-16	-2	Updated entire drawing, added millimeters	TJK

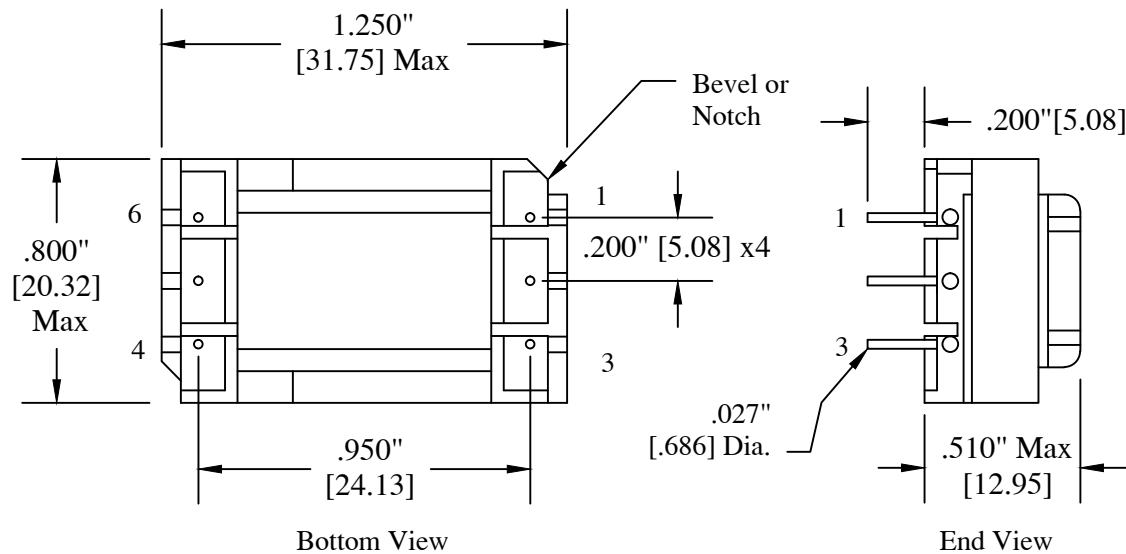

Electrical Parameters

Primary Impedance : 600Ω  
 Secondary Impedance : 600/600 Ω  
 DC Unbalance : 50mA Max  
 Turns Ratio: 1:1.41 ±2% (Tie: 3 - 5)  
 (The following transmission tests are conducted with 50 mA D.C. and a Secondary load of 1200 Ω and with Secondary #3 & 5 tied together)  
 Frequency Response (1KHz Ref.):  
 500-3500Hz +0.3, -0.7dB  
 300-3500Hz +0.3, -1.6dB  
 Insertion Loss (@1KHz) : 1.6dB Max.  
 Return Loss @ 1KHz : 14.0dB Min.  
 T.H.D. 0dBm @300Hz : -50dB Typical  
 Longitudinal Balance : 60 dB Min per IEEE #455-1985  
 DCR Primary : 75 Ω ±10%  
 Secondary (Total) : 170 Ω ±10%  
 Dielectric Strength : 1500 Vrms 1 Minute P-S-C

**Single Hybrid**

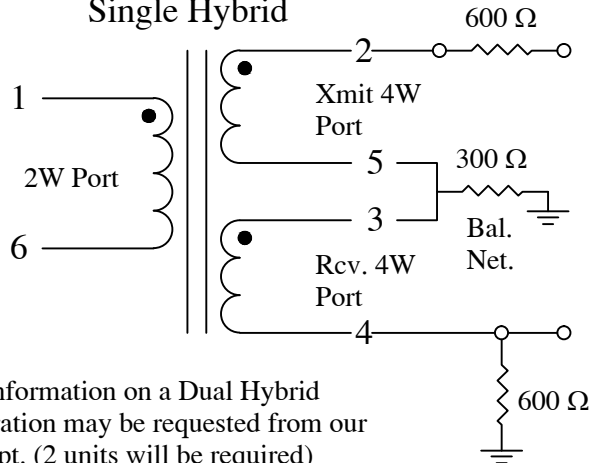

Note: Information on a Dual Hybrid configuration may be requested from our Eng. Dept. (2 units will be required)

Note: All dimensions are reference unless otherwise specified.

<b>PREM</b> MAGNETICS INCORPORATED		CUSTOM ENGINEERING MAGNETIC COMPONENTS Johnsburg, Illinois 3521 N. Chapel Hill Rd. / McHenry, Illinois 60051	
SCALE: None	APPROVED BY:	DRAWN BY Tjk	
DATE: 04/13/16	<i>Tj Klotz</i>	REVISED	
<b>Standard Product Transformer p/n SPT-2110</b>			
		DRAWING NUMBER <b>A-SPT-2110-2</b>	